

Mercury 8

HANDHELD MAGNIFIER & READER USER GUIDE

www.trysight.com



Version 1.0

Congratulations on the purchase of your Mercury 8 Handheld Magnifier with Speech. Please read the manual fully before using. Mercury 8 is an advanced handheld magnifier with highly accurate reading capabilities, allowing you to listen to printed material in a clear natural sounding voice. We hope it will serve you well. Should you have suggestions for improving the product, please email us at support@trysight.com.

Enclosed Parts:

Power Charger

Charging Cable

User Manual

Mercury 8 Handheld Device with attached legs

DEVICE LAYOUT



The headphone jack and charging port have small flaps to prevent dust and water damage. Open these flaps to use these ports.

IMPORTANT: DO NOT HOLD DOWN THE POWER BUTTON AND VOLUME BUTTON AT THE SAME TIME.

POWER ON/OFF

Hold down the Power button for 3 seconds to start the unit. The unit can take upto 1 minute to start. During this time you will see a boot logo. The unit will start in live magnification mode (locked units) or on the Android screen (unlocked units). If the unit doesn't start, the likely cause is the battery is not charged. To charge the battery, plug in the power adapter to an electrical outlet and use the provided USB cable to connect the device to the charger as shown below.

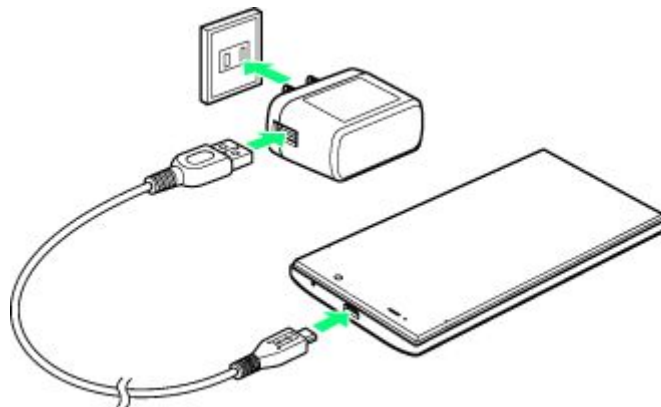

After charging for 30 minutes the unit should have sufficient power to start. To power off the unit, hold down the power button for 3 seconds.

QUICK ON/OFF

To enable quick on/off functionality, the unit can go into "Sleep" mode. The unit can wake up instantly from sleep mode in 1 second. However, Sleep mode uses a small amount of battery as the unit is not completely turned off. After several days in sleep mode, the battery will drain out and will need recharging even if you don't use the unit. To put the unit to sleep, tap the Power button quickly (Don't hold it down). You will hear a beep and the screen will turn off. To wake it up, tap the power button again.

INTEGRATED LEGS

Mercury 8 incorporates integrated foldable legs. The legs allow for easy positioning of the device over a document. The legs are comprised of a small leg and a big leg. Open the big leg and then the small leg as shown below.



MAGNIFICATION MODE

The functions of Mercury 8 can be controlled using simple touch gestures. They are as follows:

1) Single Finger Tap to Focus



2) Two Finger Pinch to Zoom In/Out



3) Three finger tap to change color

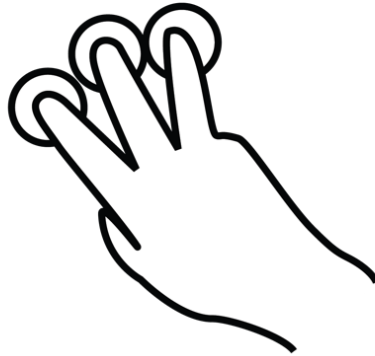

4) Four Finger Tap to Toggle LED Flash Light



5) Five Finger Tap to Freeze/Unfreeze image

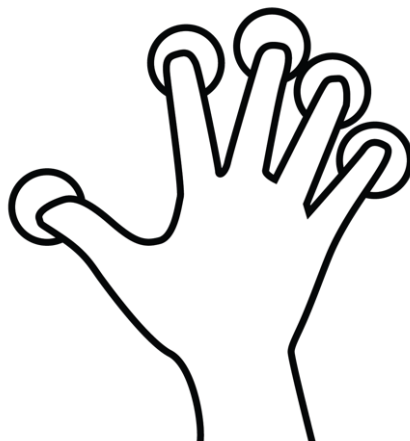

READING MODE

Tap on the red circle on the top left to enter reading mode. After tapping the button, a new interface appears. It will be similar to the image below.



Tap in the middle twice to take a picture and read it

Position the device over any document. Whatever the camera can see will be shown on screen. To take a photo and start reading tap in the center of the screen. There are icons on the bottom of the screen for advanced users. These include changing the voice, speed, saving documents etc. The functions of those icons are demonstrated using video tutorials on our website.

After you have taken the image, the device will need a few seconds to process the document. A progress bar will appear and a ticking sound will indicate that the recognition is in progress as shown below. If you wish to cancel reading, press the X on the top left.

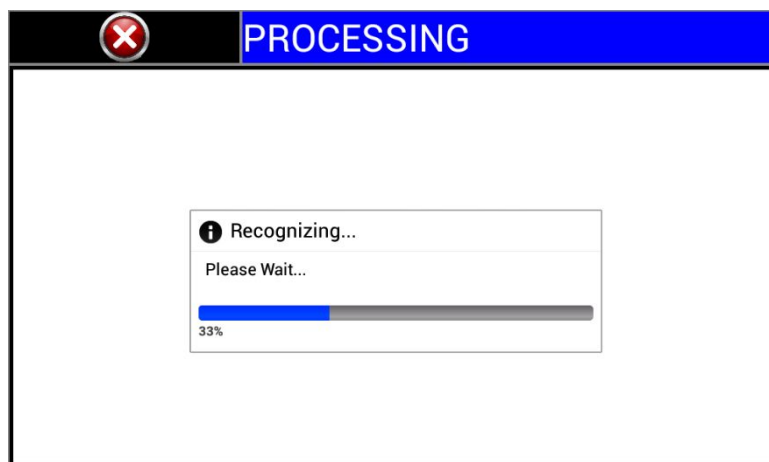

Reading should start automatically upon completion of this step.

1) Pause/Play

By default, the unit will start reading upon completion of processing. To pause, tap anywhere on the screen with a single finger. To resume, tap again with a single finger. Note that when resuming, the location you tap matters. If you tap on a specific word it will start reading from that word and not where you left off.

2) Zoom In/Out

You can zoom in/out in reading mode using the same 2 finger pinch gesture as in Magnification Mode.

3) Change Color

To change color, tap with 3 fingers

4) Panning

One of the best features in reading mode is the ability to pan around the document using touch gestures. When reading is paused, you can choose where to resume reading by simply dragging the screen to a part of the document that's relevant. To do this, hold one finger down on the screen and move it around. The document will follow your finger. Once you see what you want to read, tap it with a single finger.

5) Exit Reading Mode

To read something else, press the X on the top left. You will be taken back to the screen where you can take a photo of a document. If you

wish to exit out of that as well, press the X on the top left again and you will be back in Magnification Mode.

LOW BATTERY WARNING

When the unit has approximately 15 minutes of usable charge remaining it will alert you by beeping. The beep is a sequence of 4 quick beeps. You will hear this beep every few minutes until the device powers off by itself.

 **trysight**